

# Type NMUA

UL Listed CSA Certified Nonconductive Conduit  
Liquid-Tight Flexible Non-Metallic Conduit (LFNC)



### Construction

- One-piece construction of rigid, non-metallic reinforcement embedded in flexible PVC wall for exceptional crush and corrosion resistance.
- Durable, sunlight resistant and flame retardant thermoplastic PVC that resists heat, oil and chemical breakdown.
- Convenient markings in feet for easy measurement.

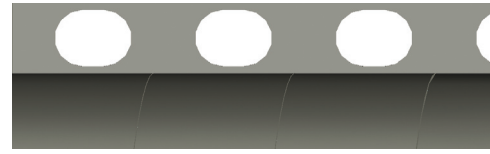

Rigid PVC Reinforced 3/8" through 2"

### Installation

- Conduit used with standard connectors for non-metallic conduit **Type B** for easy installation. IP 67 Rated when installed with approved connectors.
- Approved for both exposed and concealed locations. Rated for temperature ranges of -17°F to +176°F (-27°C to +80°C).
- Complies with NEC Article 356 and UL Standard 1660 File No. E-211327; CSA C22.2 File No. 020817.
- Easy to install and cuts easily.
- Manufactured in a full range of trade sizes from 3/8" through 2".
- Approved for direct burial and in concrete trade sizes 3/8" through 2".

### NEC Articles

- Article 250.102 Equipment Bonding Jumpers
- Article 250.134 (B) Equipment Grounding
- Article 356 Liquid-Tight Flexible Nonmetallic Conduit (LFNC-B)
- Article 501.10 (B) (2) Class I Div. 2
- Article 502.10 (A) (2) and (B) (2) Class II Div. 1 & 2
- Article 503.10 (A) and (B) Class III Div. 1 & 2
- Article 620.21 Elevator Wiring Methods
- Article 645.5 (D) (2) Information Technology Equipment

[www.ul.com](http://www.ul.com)      [www.csa-international.org](http://www.csa-international.org)  
[www.nfpa.org](http://www.nfpa.org)      [www.naed.org](http://www.naed.org)  
[www.nema.org](http://www.nema.org)      [www.anametelectrical.com](http://www.anametelectrical.com)

U.L. LISTED • CSA CERTIFIED • RoHS WEEE COMPLIANT

## Type NMUA

Gray thermoplastic PVC



### Product Specifications

### Ordering Information

Electrical Trade Size		Inside Diameter		Outside Diameter		Approx Inside Bend Radius	Approx Weight lbs.	Standard Carton		Standard Reels	
Inches	mm	Inches		Inches				PER 100 FT.	Length Feet	NAED PIN	Length Feet
		MIN.	MAX.	MIN.	MAX.	Inches					
3/8	12	.485 – .505		.690 – .710		2.0	13	100	39702	1000	39708
1/2	16	.620 – .640		.820 – .840		3.5	14	100	39712	1000	39713
3/4	21	.820 – .840		1.030 – 1.050		4.5	16	100	39722	700	39724
1	27	1.041 – 1.066		1.290 – 1.315		6.5	26	100	39731	500	39734
1-1/4	35	1.380 – 1.410		1.635 – 1.660		8.0	34	50	39741		
1-1/2	41	1.575 – 1.600		1.865 – 1.900		9.0	45	50	39753		
2	53	2.020 – 2.045		2.340 – 2.375		11.0	62	50	39761		

#### TYPICAL SPECIFICATION:

Conduit shall be Anaconda SEALTITE® Type NMUA. Conduit shall be constructed of non-metallic PVC material and shall be used for inside, outside and corrosive applications in accordance with Article 356 of the National Electric Code. Conduit shall be used in applications requiring a temperature range of -17°F to +176°F (-27°C to +80°C) for dry locations. Conduit shall be UL listed and CSA certified as **Type "B"** non-metallic conduit. Conduit IP 67 rated when installed with approved end connectors.