

Type RWS

Flexible Steel Conduit
UL Listed Flexible Metal Conduit (FMC)



Construction

- Constructed of continuously interlocked, zinc-coated steel strip.
- Flexible with high crush resistance.
- Smooth exterior and interior allow for easy pulling and wire fishing.

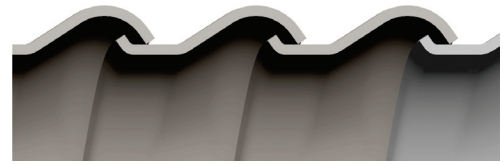

Angle-Lock Design 3/8" through 4"

Installation

- Uses standard flexible metal conduit connectors.
- Continuous grounding contact.
- UL Listed Standard #1, File # E98045.
- Manufactured in size range from 3/8" through 4".
- Complies with Article 348, NEC.
- Permitted to be used in exposed and concealed locations (Article 348.10); enclosed motor leads (Article 430.245(B)); elevators, escalators, wheelchair lifts (Article 620.21).
- +450°F Maximum temperature.

NEC Articles

- Article 250.102, 250.118(5) and 250.134(B) Equipment Grounding.
- Article 348 Flexible Metal Conduit. (FMC)
- Article 501.30 (B) Class I Div. 1 & 2.
- Article 502.30 (B) Class II Div. 1 & 2.
- Article 503.10 (B) Class III Div. 1 & 2.
- Article 620.21 Elevator Wiring Methods
- Article 645.5 (D) (2) Information Technology Equipment

www.ul.com
www.nema.org

www.naed.org
www.anametelectrical.com

• UL LISTED  • RoHS WEEE COMPLIANT

Type RWS

Flexible steel conduit

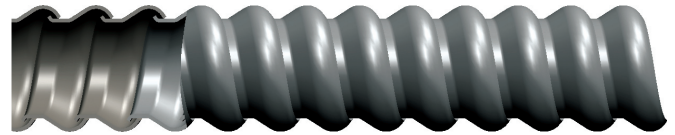

Product Specifications

Ordering Information

Electrical Trade Size		Inside Diameter		Outside Diameter		Approx Inside Bend Radius	Approx Weight lbs.	Standard Coils		Standard Reels	
Inches	mm	Inches		Inches				PER 100 FT.	Length Feet	NAED PIN	Length Feet
		MIN.	MAX.	MIN.	MAX.	Inches					
3/8	12	.375	.393	.560	.610	2	18	100	455503	1000	455507
1/2	16	.625	.645	.860	.920	3	28	100	455513	1000	455517
3/4	21	.812	.835	1.045	1.105	4	33	100	455523	1000	455527
1	27	1.000	1.040	1.300	1.380	5	51	50	455532	300	455533
1-1/4	35	1.250	1.300	1.550	1.630	6-1/4	63	50	455542	200	455543
1-1/2	41	1.500	1.575	1.850	1.950	7-1/2	76	25	455551	150	455553
2	53	2.000	2.080	2.350	2.450	10	100	25	455561	100	455563
2-1/2	63	2.500	—	2.860	3.060	12-1/2	165	25	455571	—	—
3	78	3.000	—	3.360	3.560	15	197	25	455581	—	—
3-1/2	91	3.500	—	3.860	4.060	17-1/2	230	25	455601	—	—
4	103	4.000	—	4.360	4.560	20	263	25	455591	—	—

TYPICAL SPECIFICATION:

Conduit shall be Anaconda Type RWS. Conduit shall provide flexible raceway for wiring and shall be constructed of continuously interlocked hot dipped zinc galvanized steel. Conduit shall be UL listed in electrical trade sizes 3/8" thru 4".